

INSTRUCTION MANUAL

60KG (130LB) PUSH SPREADER

MODEL NO: WBS130

EN - ORIGINAL INSTRUCTIONS

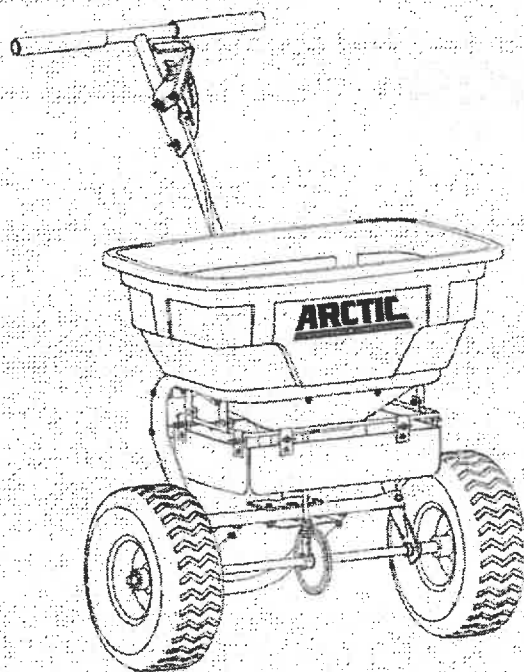

ASSEMBLY REQUIRED
SAVE THESE INSTRUCTIONS
SPARES & SUPPORT

FOR YOUR SAFETY

Please read & understand this manual, paying attention to the safety instructions, before use.

Incorrect use of the product could put the operator or machine in danger.

Whilst every effort has been made to ensure the accuracy of information contained in this manual, our policy of continuous improvement determines the right to make modifications without prior warning.

Images used are for illustration purposes only

CONTENTS

SPECIFICATION

IMPORTANT INFORMATION

GENERAL SAFETY INSTRUCTIONS

COMPONENTS

ASSEMBLY

OPERATION

MAINTENANCE

PARTS DIAGRAM

PARTS LIST

ASSEMBLY IS REQUIRED - MINIMUM TWO PERSONS

- This product requires assembly before use.
- See "Assembly" section for instructions.
- Due to the weight and size of the machine, it is recommended that another adult assist with the assembly.
- Inspect all components closely upon receipt to make sure no items are missing or damaged.



WARNING

Read this instruction manual carefully before operating this machine. Make sure that you are familiar with the controls and properly operate the machine. Following these instructions can reduce the risk of personal injury.

FOR BEST PERFORMANCE PLEASE USE REFINED ICE MELT AND CLEAN THE SPREADER THOROUGHLY AFTER USE WITH REFINED DE-ICING SALT.

Using rock salt in this spreader may damage the mechanism and shorten the product's lifespan. Refined ice melting salt can be used but the user should be aware that this is not a specialised salt spreader and using salt may corrode the spreader and reduce the life of the machine. Clean the spreader thoroughly after using refined de-icing salt.

SPECIFICATIONS

The manufacturer reserves the right to change the product specification and livery according to continued product improvements.

Model	WBS130
Capacity (Weight)	60kg (130lb)
Hopper Dimensions (cm)	71X46X34
Overall Dimensions (cm)	92X78X102
Product Weight (kgs)	19
Tire Rating	2 Ply
Tire Maximum PSI	20psi (Do not exceed)

IMPORTANT INFORMATION

INTENDED USAGE



WARNING

No one should ever ride on the spreader.

Read this instruction manual carefully before operating this machine. Make sure that you are familiar with the controls and properly operate the machine. Following these instructions can reduce the risk of personal injury.

The spreader is designed for use in private gardens and primarily for spreading granular material in and around domestic gardens. Ideal for fertiliser, granules, grass seed etc. This product can be used with refined ice melting salt, but please clean the spreader thoroughly after use with refined de-icing salt. Please note that this product cannot be used with Rock Salt.

Extended use over abrasive surfaces (e.g. concrete, tarmac, paving etc.) could cause premature wear on the spreader tires. Commercial or industrial environments are not recommended.

Generally acknowledged accident prevention regulations and enclosed safety instructions must be observed. Only perform work described in these instructions for use, any other use is incorrect. The manufacturer will not assume responsibility for damage resulting from such use.

IF NOT USED PROPERLY THIS MACHINE CAN BE DANGEROUS!

This machine can cause serious injury to the operator and others, the warning and safety instructions must be followed to ensure reasonable safety and efficiency in using this product. The operator is responsible for following the warning and safety instructions in this manual and on the machine. Never use the product unless the components are correctly positioned and operational.

TRAINING









Read the instructions carefully: Be familiar with the controls and the proper use of the equipment.

Never allow children or people unfamiliar with these instructions to use the product.

Local regulations can restrict the age of the operator. Keep in mind that the operator or user is responsible for accidents or hazards involving the machine that occur to other people or their property.

GENERAL SAFETY INSTRUCTIONS

It is important that you read and understand the owner's manual and labels affixed to the machine. Learn its application and limitations as well as the specific potential hazards. Retain these instructions for future reference. The operator is responsible for following the warnings & instructions in this manual and on the product.

	Read & understand the operator's manual for the spreader. Failure to follow instructions could result in death or serious injury.		Risk of Slicing. Keep hands out of the way of all moving parts.
	Wear gloves to protect your hands. Wear recognised eye protection at all times.		Check your machine before using. Keep guards in place and in working order. Frequently check to see that foreign objects are removed before using. Replace damaged, missing or failed parts before using it.
SLOPES	Be careful when using on slopes. Do not operate on inclines greater than 15°. It is advised to work across the incline, not up and down.		Safety alert symbol. Used to alert you to potential personal injury hazards. Obey all safety messages that follow this symbol to avoid possible injury.
 DANGER	Indicates an imminently hazardous situation which, if not avoided, will result in serious injury.	 WARNING	Indicates a potentially hazardous situation which, if not avoided, could result in serious injury.
 CAUTION	Indicates a potentially hazardous situation which, if not avoided, may result in minor or moderate injury.	CAUTION	Used without the safety alert symbol indicates a potentially hazardous situation which, if not avoided, may result in property damage.

IMPORTANT SAFETY WARNINGS



TO REDUCE RISK OF INJURY: Before any use be sure everyone using this product reads and understands all safety instructions and other information contained in this manual.



WARNING

The warnings, cautions, and instructions outlined in this instruction manual cannot cover all possible conditions or situations that may occur. It must be understood by the operator that common sense and caution are factors which cannot be built into this product and must be supplied by the operator.

GENERAL SAFETY

STAY ALERT

Do not operate the machine while under the influence of drugs, alcohol, or any medication that could affect your ability to use it properly. Do not use this machine when you are tired or distracted from the job at hand. Be aware of what you are doing at all times. Use common sense.

SMALL COMPONENTS

Contains small components that could be a choking hazard if swallowed. Keep these items away from children.

USERS, BYSTANDERS AND CHILDREN

Do not at any time carry passengers in or on the spreader, stationary or whilst moving. Do not allow any person, child or pet to play on, stand, sit, lay or climb in or on the spreader. Never allow children or people unfamiliar with these instructions to use the spreader. Local regulations can restrict the age of the operator. Keep unauthorised persons a safe distance away from the machine. If approached, stop the machine immediately.

AVOID DANGEROUS CONDITIONS

Work in daylight or in good artificial light; walk, never run with the machine; always be sure of your footing on slopes; exercise extreme caution when changing direction on slopes; do not work on excessively steep slopes; use extreme caution when reversing or pulling the machine towards you; do not put hands or feet near or under rotating or moving parts. When operating on slopes, across the incline.

INSPECT YOUR MACHINE

Check all bolts, nuts, and screws for tightness before each use, especially those securing guards and drive mechanisms. Vibration during use, may cause these to loosen. Form a habit of checking to see that all other tools/equipment are removed from the working area before operating. Replace damaged, missing or failed parts before using. Warning labels carry important information. Replace any missing or damaged warning labels.

DRESS PROPERLY

Be careful of loose clothing and other accessories (watches, necklaces etc.) which can be caught in moving parts. Long trousers are advisable. Always wear substantial non-slip footwear when operating. Never operate barefoot or when wearing sandals. Wear a face or dust mask if the operation is dusty. Wear protective hair covering to contain long hair, preventing it from getting caught in machinery.

DO NOT OVERREACH

Always keep proper footing and balance when operating. Use on slopes with great care. Never stand on the machine. Serious injury could occur if the machine is tipped or if the moving parts are unintentionally contacted. Do not store anything above or near the machine, where anyone might stand on the machine to reach them.

DO NOT FORCE TOOL

Do not exceed maximum load capacity of 60kg (130lb). Avoid large holes and ditches when transporting loads. Always work within the rated capacity. Do not use for a purpose for which it was not intended. Be careful when operating on steep slopes, the spreader may tip over. Always operate at reduce speed in rough terrain, along creeks, ditches and on hillsides. To avoid personal injury and/or equipment damage **DO NOT EXCEED 10 MPH**. Always use caution when loading and unloading the hopper.

INSPECT

Before using, always visually inspect to see that the machine is not worn or damaged. Replace worn or damaged elements and bolts in sets, to preserve balance.

MAINTAIN YOUR MACHINE WITH CARE

Clean the machine immediately after use. Keep the machine clean to ensure it operates to its full and safest performance. When maintaining this machine, only the manufacturer's original replacement parts should be used. The use of non-original manufacturer parts may invalidate your warranty.

PROTECT THE ENVIRONMENT

Take leftover materials to an authorized collection point or follow the local regulations in your country where the machine is used. Do not discharge into drains, soil or water.

STORE IDLE EQUIPMENT

When not in use, store in a dry location. Keep the machine away from children and others not qualified to use it. Keep away from direct sunlight.

TIRE INFLATION

Before operating, make sure the tires have the recommended pressure of 20 PSI (**Do not exceed 20 PSI**). We recommend using foot or hand inflation devices only. This is a garden/domestic spreader, therefore extended use over abrasive surfaces (e.g. concrete, tarmac etc.) could cause premature wear on the tires.

KNOW YOUR MACHINE

Read this owner's manual before operating the equipment. Familiarize yourself with the location and function of the controls and features. Save this manual for future reference.

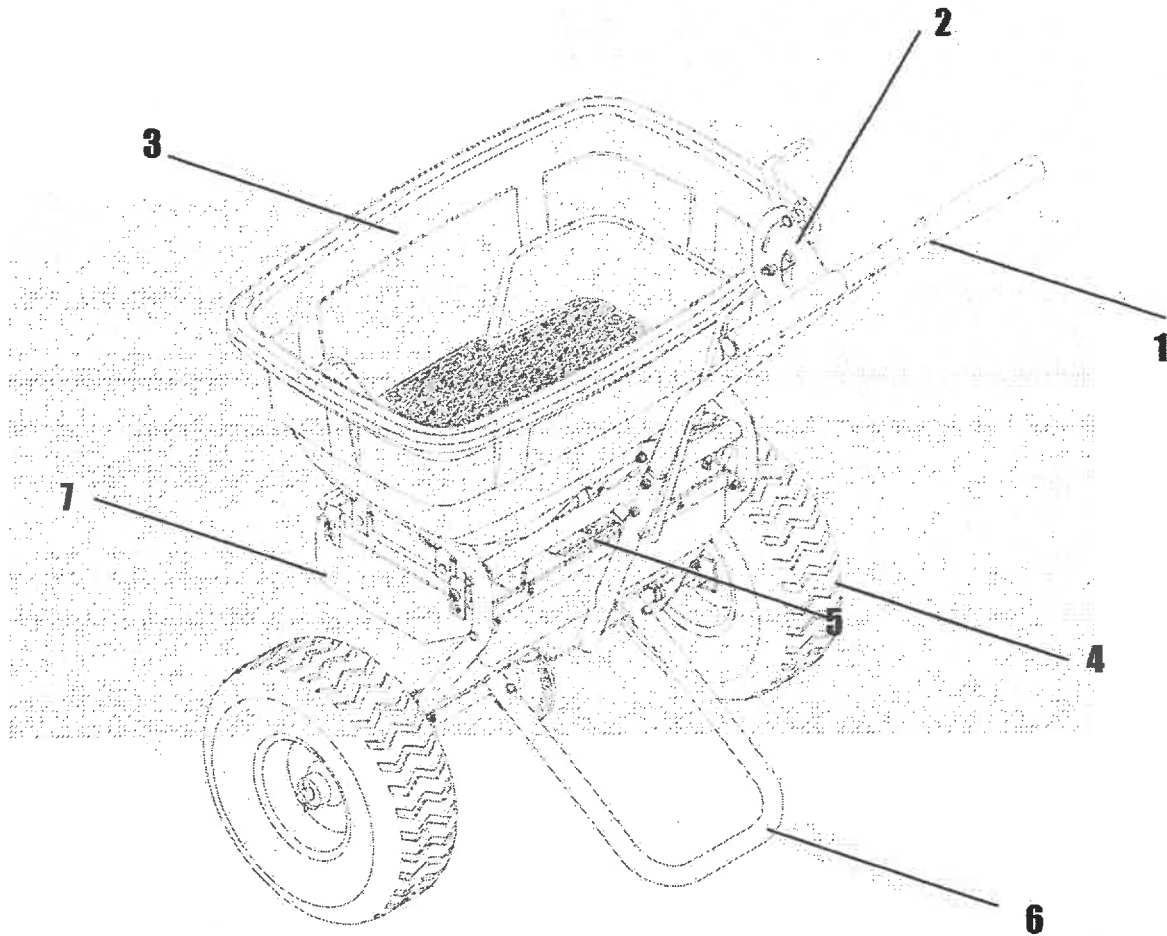

1. **T-Handle** – Pushes and moves the spreader easily.
2. **Flow Control** – Controls the flow of material being spread
3. **Hopper** – Do not exceed rated load capacity 130lb (60kgs).
4. **Tyre/Wheel** – Do not exceed recommended inflation rated 20 PSI.
5. **Impeller** - Evenly distributes material.
6. **Support Leg** – Stabilizes load and spreader, when stationary.
7. **Baffle combination** — Help adjust the seeding range.

Components

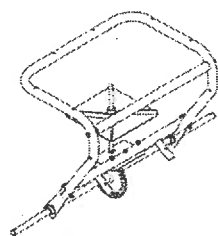

Frame Tube Assembly
1pc

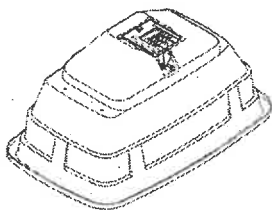

Hopper
1pc

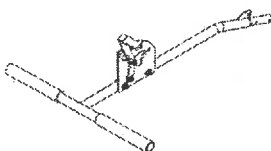

Handle Preassembly
1pc



Support Tube
1pc



Adjustment Lever
1pc



Support Leg
1pc

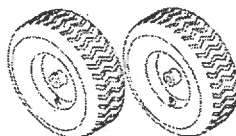

Wheel
1pc



Screen
1pc

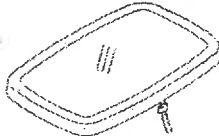

Rain cover
1pc

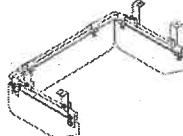

Baffle Assembly
1pc



Rear Baffle
1pc



Hex Bolt M8*75
1pc



Hex Bolt M6*40
8pcs



Hex Bolt M6*35
4pcs



Hex Bolt M6*20
1pc



Lock Nut M8
3pcs



Lock Nut M6
13pcs



R Pin
1pc



Flat Washer Φ16
6pcs



Flat Washer Φ8
2pcs



Large Flat Washer Φ6
6pcs



Flat Washer Φ6
2pcs



Spring Washer Φ6
3pcs

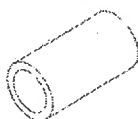

Tire Bushing
2pcs

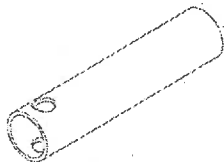

Tire Spacer
2pcs

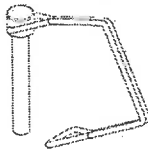

Drive Pin
2pcs



Spacer
2pcs



Cotter Pin Φ5*35
2pcs

STEP 1 - Wheels

1. Put the two sides of the U-shaped support leg on the connecting shaft of the frame tube assembly, align the upper holes, and secure them with two hex bolts M6x35 and two lock nuts M6.
2. Install the tire spacer, tire bushing and tire on the axle in turn, and assemble it with a flat washer $\varnothing 16$ and a cotter pin $\varnothing 5 \times 35$ outside. Once the hole on the right inside of the tire is aligned with the hole on the tire bushing, secure it with a drive pin.

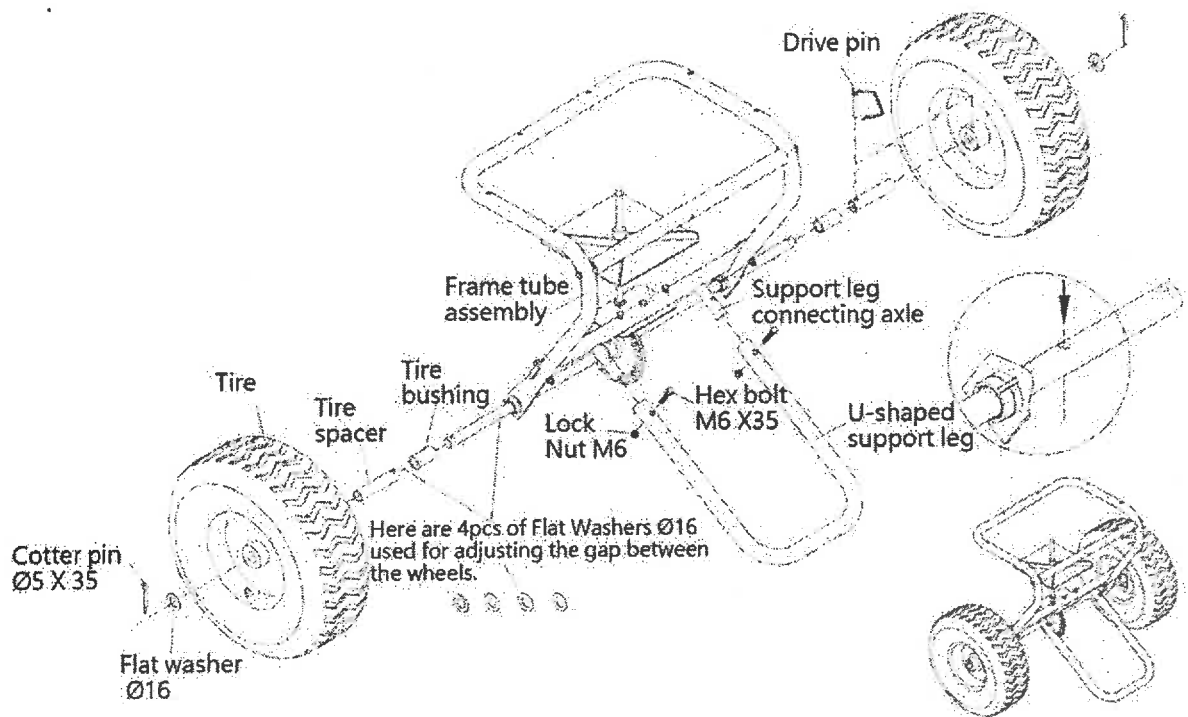

Figure1

Step 2

As shown in Figure 2, install the mounting plate of the support tube to the transverse tube using 2 hex bolts M6x40, 2 large washers Ø6 and 2 lock nuts M6.

Connect the upper part of the support tube to the tube above the frame tube assembly with one hex bolt M8x75, one spacer and one lock nut M8.

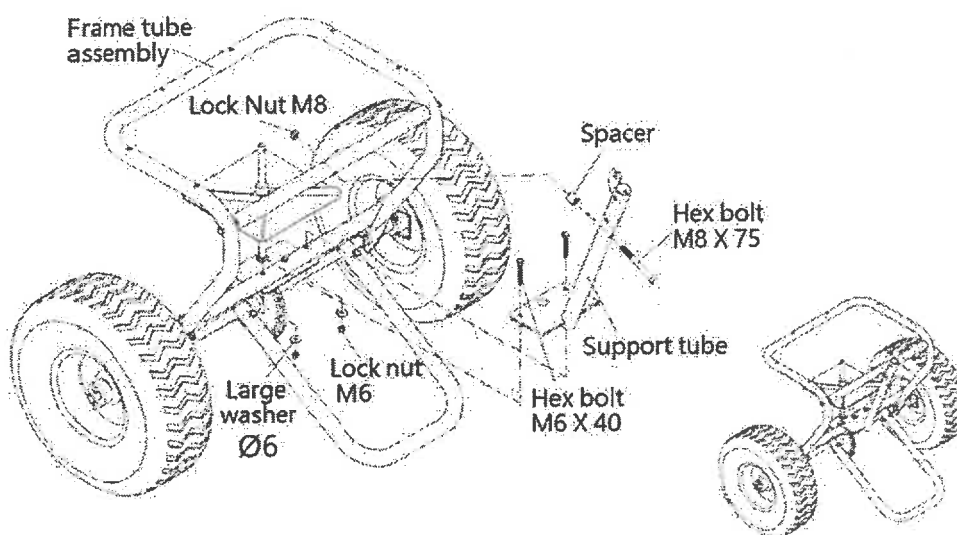

Figure 2

Step 3 - Hopper and Baffle

1. The head of the rotating shaft of the frame passes through the center hole of the hopper.

Place the hopper component on the frame component. Use 6 hex bolts M6×40 and 6 large washers 06 to pass through the holes of the hopper and the frame assembly. Install the baffle assembly together under the frame assembly.

Assemble it with 6 lock nuts M6 and bolts.

2. Inside the hopper, install one R pin 03 on the small hole at the head of the rotating shaft.

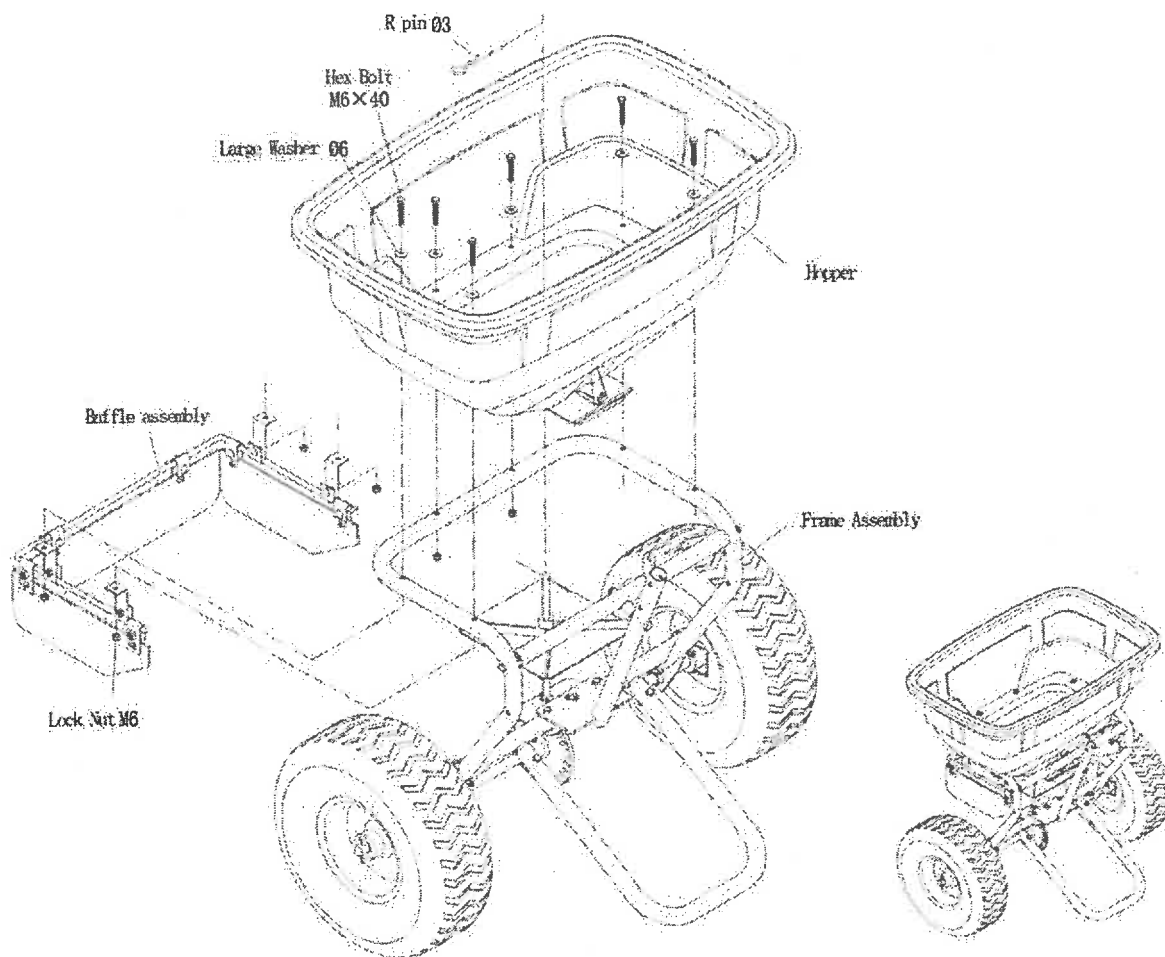

Figure 3

Step4 - Connecting handle And Rear Baffle

As shown in Figure 4, insert the lower end of the handle preassembly into the support tube of the frame tube assembly, connect the pipe with two hex bolts M6x35, two spring washers Ø6 and two lock nuts M6, and secure the handle connection plate with one hex bolt M6x20, two flat washers Ø6, one spring washer Ø6 and one lock nut M6.

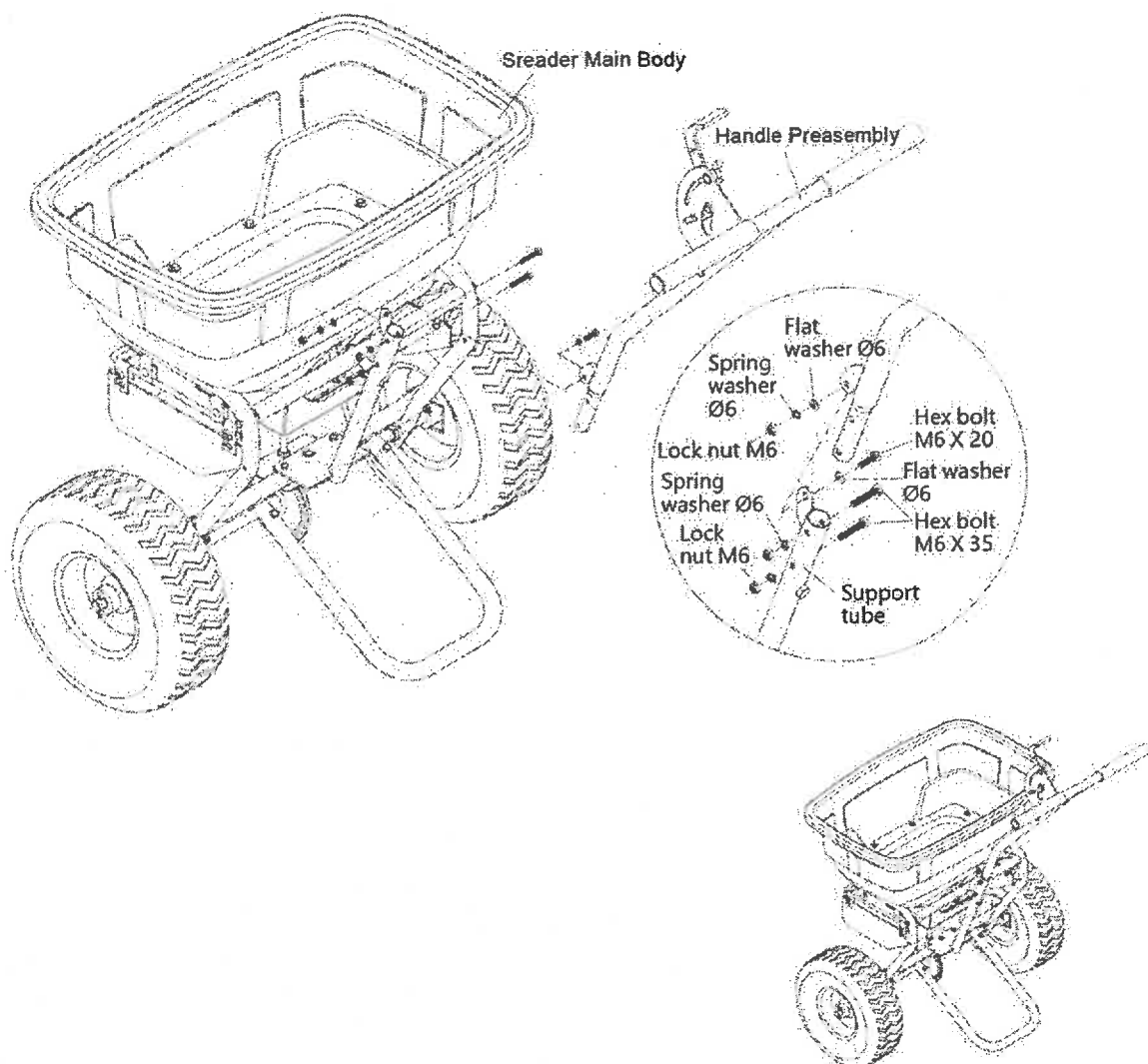
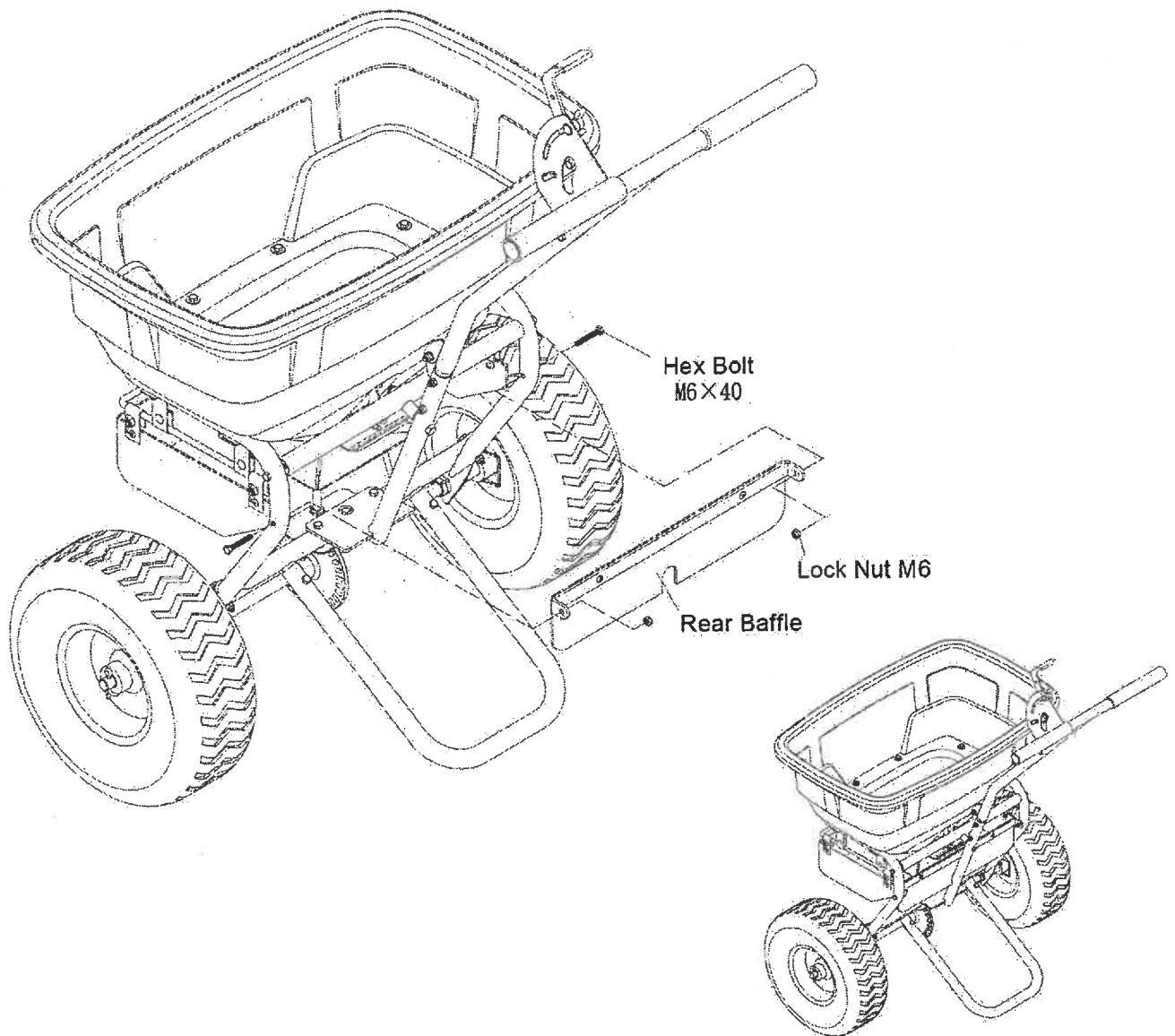

Figure 4

Install the rear baffle to the rear of the frame with two hex bolts M6×40 and two Lock nuts M6.



Step 5 - Solid Linkage

As shown in Figure 5, use a flat washer $\varnothing 8$ and a nylon lock nut M8 to connect the upper end of the adjustment lever to the connecting lever connecting plate mounting hole of the adjusting handle component, and then use another flat washer $\varnothing 8$ and a nylon lock nut M8 to connect the lower end of the adjustment lever to the connecting lever fixing plate mounting hole at the bottom of the hopper.

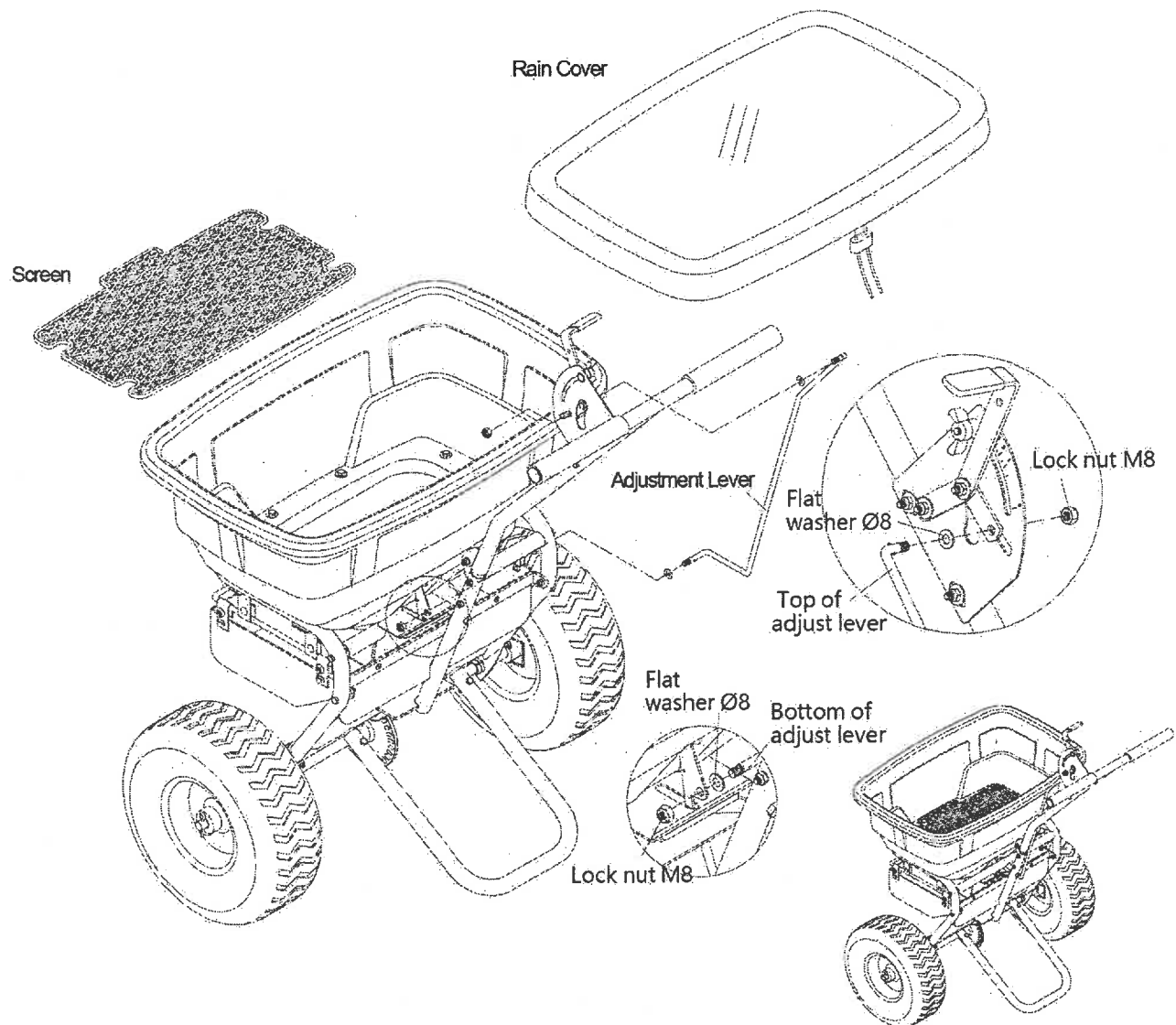

Figure 5

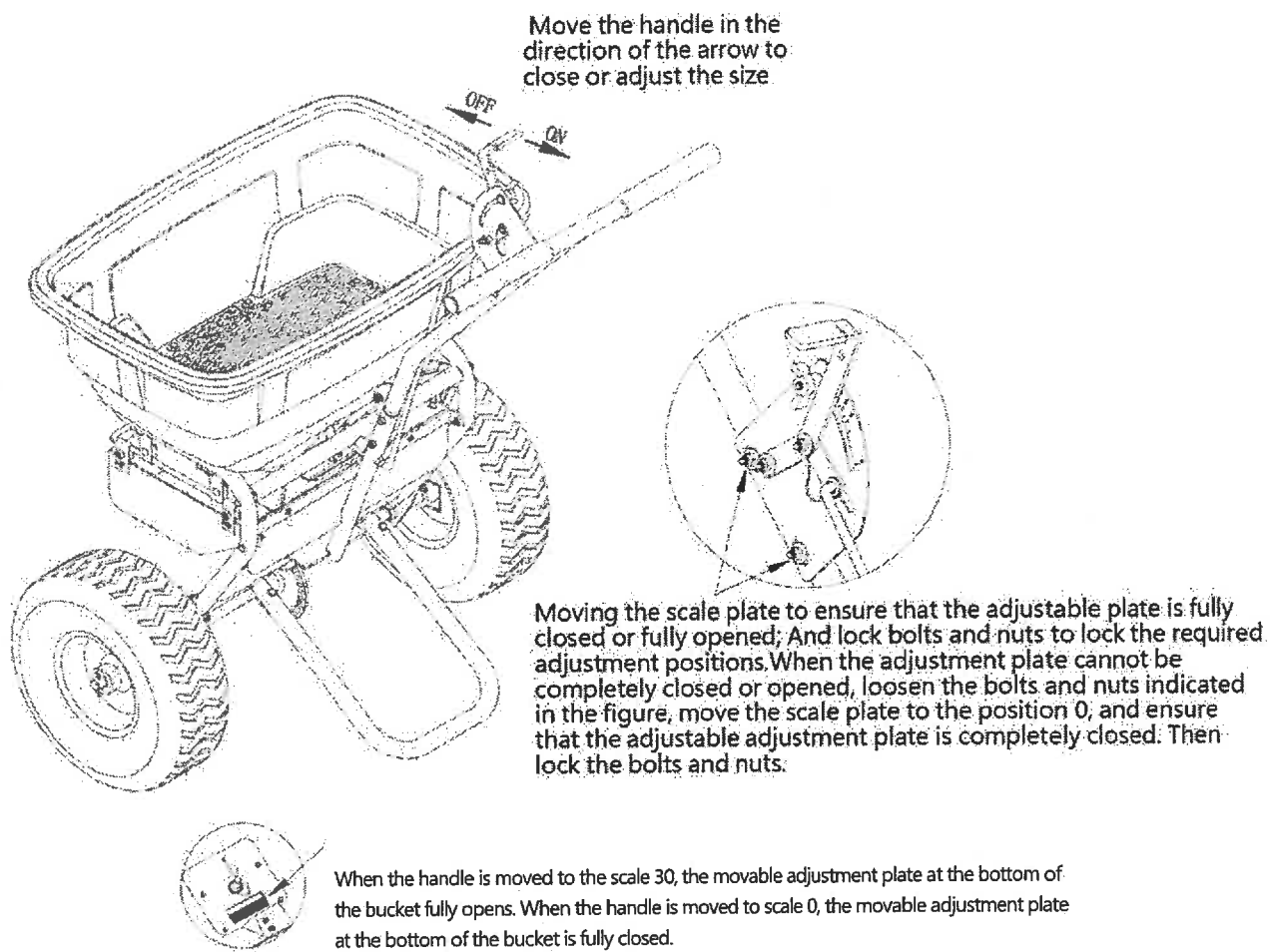

Figure 6

OPERATION



DANGER

The product must only be put into operation if no defects are found. It is crucial that any defective parts are replaced before the product is used again. Check the safety equipment and the safe condition of the product: Check all parts to make sure that they fit tightly. Check whether there are any visible defects: broken parts, cracks, etc.



DANGER

DO NOT EXCEED THE EQUIPMENT MAXIMUM LOAD CAPACITY OF 60kg (130lb).

Before filling the hopper, familiarise yourself with the operation of this Spreader.

- The Spreader is designed to be pushed at 3 miles per hour – brisk walking pace. Walking speed will affect the spread pattern and flow rate.
- Move the Wing Nut attached to the stop bolt on the gauge to the relevant setting.
- Start pushing the Spreader forward & pull the control lever back to the stop bolt, opening the feed-gate hole at the bottom of the hopper.
- If the Spreader does not spread evenly, ensure that the FRONT of the gearbox points towards the front of the Spreader. The impeller must rotate clockwise.
- Material stuck on the impeller blades will cause uneven spreading.
- To stop spreading, push the gauge lever forward to close the feed-gate hole in the hopper.
- Remove the agitator when using refined de-icing salt to reduce gearbox damage. Salt may corrode the machine and reduce its working life. **DO NOT USE ROCK SALT.**
- If fertiliser is accidentally deposited too heavily in a small area, soak the area thoroughly with a garden hose or sprinkler to prevent burning the lawn.
- When broadcasting weed control fertilizers, make sure the broadcast pattern does not hit evergreen trees, flowers or shrubs.
- Always use the rain cover in wet weather conditions to keep the hopper contents dry.

RATE SETTINGS

Our spreaders are designed to spread dry, powdered or granulated materials thinly and evenly over reasonably smooth surfaces. Due to the many hundreds of different materials which can be used with this spreader, it is impossible to list them all and the relevant spreader setting for the material. We therefore recommend that you test the spread pattern on a hard surface (driveway etc), before passing over the area to be treated.

1. Inspect your spreader before each use. Make sure the wheels turn easily, and the impeller still moves when the spreader is pushed. The hopper should be clean and free from cracks.
2. Determine approximate square footage of the area to be covered and estimate amount of material required. Please refer to the spreader setting instructions later in the manual.
3. Spreader is useful for spreading a range of materials (Ice Melt, Fertilizer, Grass Seed). Materials such as Powder, Manure, Top Soil, Gravel, and Mulch have the wrong physical characteristics and should not be used with these spreaders.
4. Before filling the hopper, make sure that the flow control lever and the flow control plate are closed.
5. Make sure the R pin is installed through the gearbox spindle in the hopper before starting the spreader.
6. Break up any lumpy material as you fill the hopper.
7. Once you have determined your proper spreader setting and are using the spreader, keep the following thoughts in mind to optimize spreading results: Always set the adjustable stop with the flow control to the "0" position and continue moving one more stride whenever you are about to stop or turn the spreader. This action will close the flow control plate and stop the dispersing of material, which will result in reduced waste and avoid damaging the lawn with oversaturated material.
8. To maintain the same coverage when walking at a different speed, adjust the flow rate. Reduce the flow setting for slower speeds and increase the flow setting for higher speeds.
9. Keep the impeller plate horizontal when operating. Tilting the spreader will result in uneven coverage.

10. Always start walking prior to opening the flow control closure plate.
11. If spreading material is accidentally deposited too heavily in a small area, soak the area thoroughly with a garden hose or sprinkler to prevent burning of the lawn.
12. To ensure consistent coverage, make sure each scatter pattern slightly overlaps as shown in figure below. The approximate scatter widths for different materials are shown in the application chart.
13. When scattering spreading material, make sure material does not hit evergreen trees, flowers or shrubs.
14. Make sure you are appropriately dressed, including sturdy footwear. Protect yourself by wearing gloves and a dust mask when handling chemical lawn products that contain pesticides and herbicides.
15. Do not over apply spreading material. Follow the recommended coverage rate for each product. Over application will lead to lawn damage and contamination.



CAUTION

The rate settings are guidelines only. Even branded materials may vary in grain size, humidity, density etc. If in any doubt choose a lower setting than that suggested or start at a mid-setting and adjust as necessary, until an even spread is achieved.

DO NOT USE WITH ROCK SALT.

Using rock salt in this spreader will damage the mechanism and shorten the life of the product. Refined ice melting salt can be used but the user should be aware that this is not a specialised salt spreader and using salt may corrode the spreader and reduce the life of the machine. Clean the spread thoroughly after using refined de-icing salt.



WARNING

Do not over apply spreading material. Follow the recommended coverage rate for each product. Over application will lead to damage and contamination. If spreading material accidentally deposits too heavily, soak the area thoroughly with a garden hose or sprinkler to prevent burning.

CONSISTENT COVERAGE

To ensure consistent coverage, ensure each broadcast pattern slightly overlaps the previous, as shown below.
N.B. ALWAYS MOVE OFF BEFORE OPENING FEED-GATE. ALWAYS CLOSE FEED-GATE BEFORE STOPPING.

SPREADER SETTING INSTRUCTIONS

FOR MATERIALS THAT USE A TYPICAL 5,000 Sq. Ft. 10,000 Sq. Ft. & 15,000 Sq. Ft. COVERAGE VALUE

See additional spreader setting instructions on the following pages if your material coverage value is not typical.

To obtain the proper spreader setting for the material being spread, follow these steps:

1. Find the total weight in lbs. Of the product from the product label on the bag of material. Reference the nearest corresponding row in Chart A.
2. Find the coverage amount in square feet that the product is rated for from the product label on the bag of material. Reference the corresponding column in Chart A.
3. Find the nearest intersecting point of these two numbers from Chart A. (this number equals the lbs. per 1000 sq. ft.)
4. Use this number to find the nearest number in the column "lbs. / 1000 sq. ft." on Chart B to obtain the spreader setting.
5. You may have to approximate your spreader setting based upon the lbs. per 1000 sq. ft. number that you arrived at.

As an example:

1. *The fertilizer bag weighs 42 lbs.*
2. *The coverage value is rated at 15,000 square feet.*
3. *Use Chart A to find the corresponding column of coverage and nearest row of weight. The nearest intersecting point is approximately 2.8 since the bag weight is between 40 lbs. and 45 lbs.*
4. *Using Chart B, the number 2.8 is between 2 lbs. per 1000 sq. ft. and 3 lbs. per 1000 sq. ft.*
5. *Spreader setting would be 14.*

CHART A – SQUARE FOOT COVERAGE PER BAG*

(*) These are only estimates. Actual amounts may vary.

Weight Of Bag (LBS.)	LBS/1,000 SQ FT		
	5,000 SQ FT	10,000 SQ FT	15,000 SQ FT
5	1.0	0.5	0.3
10	2.0	1.0	0.7
15	3.0	1.5	1.0
20	4.0	2.0	1.3
25	5.0	2.5	1.7
30	6.0	3.0	2.0
35	7.0	3.5	2.3
40	8.0	4.0	2.7
45	9.0	4.5	3.0
50	10.0	5.0	3.3

CHART B – SPREADER SETTINGS/SPREAD WIDTHS*

(*) These are only estimates actual spreader setting and widths may vary depending on material.

LBS/1,000 SQ FT	SPREADER SETTING	SMALL PARTICLE SPREAD	MEDIUM PARTICLE SPREAD	LARGE PARTICLE SPREAD
1	10	5-6 ft.	6-9 ft.	9-12 ft.
2	12	5-6 ft.	6-9 ft.	9-12 ft.
3	14	5-6 ft.	6-9 ft.	9-12 ft.
4	15	5-6 ft.	6-9 ft.	9-12 ft.
5	17	5-6 ft.	6-9 ft.	9-12 ft.
6	18	5-6 ft.	6-9 ft.	9-12 ft.
7	20	5-6 ft.	6-9 ft.	9-12 ft.
8	21	5-6 ft.	6-9 ft.	9-12 ft.
9	23	5-6 ft.	6-9 ft.	9-12 ft.
10	25	5-6 ft.	6-9 ft.	9-12 ft.

ADDITIONAL INSTRUCTIONS

FOR MATERIALS THAT DO NOT USE A TYPICAL 5,000 Sq. Ft, 10,000 Sq. Ft. & 15,000 Sq. Ft. COVERAGE VALUE

To obtain the proper spreader setting for the material being spread, follow these steps:

1. Find the total weight in lbs. of the product from the product label on the bag of material.
2. Find the coverage amount in square feet that the product is rated for from the product label on the bag of material.
3. Divide the bag weight rated in lbs. by the square feet coverage rated on the bag.
4. Take this result and multiply it by 1000.
5. This final number is the lbs. of material to be spread per 1000 square feet.
6. Use this number in Chart B to obtain the proper spreader setting.

As an example:

1. The fertilizer bag weighs 10 lbs.
2. The coverage value is rated at 2000 square feet.
3. $10 \text{ lbs.} / 2000 \text{ square ft.} = 0.005$
4. $0.005 \times 1000 = 5 \text{ lbs. per 1000 sq. ft.}$

Using this number in Chart B, you would obtain a spreader setting of 17.

MAINTENANCE**LUBRICATE**

Maintenance spray or multi-purpose grease can be applied to the wheel axle prior to long-term storage. Oiling is not necessary.

GEARBOX

DO NOT open the gearbox. The gears are permanently lubricated from the factory and do not need lubricating.

CHECK TIRE INFLATION

Prior to using the spreader, ensure the tires are sufficiently inflated. We recommend using foot or hand inflation devices only. **Do not inflate above 20psi.**

CLEANING

After each use thoroughly wash the spreader and clean material out of the hopper.

STORING

Never allow material to stay in the hopper for extended periods of time.

Before storing, ensure that the spreader is clean and dry.

Store indoors or in a protected area during severe weather and in the winter months.

CHECK ALL NUTS, BOLTS AND FASTENING

Periodically check all fastenings are tight & secure.

NEVER EXCEED LOAD CAPACITY

To avoid damaging the spreader, never exceed the rated load capacity of 60kg (130lb).

PARTS DIAGRAM-WBS130

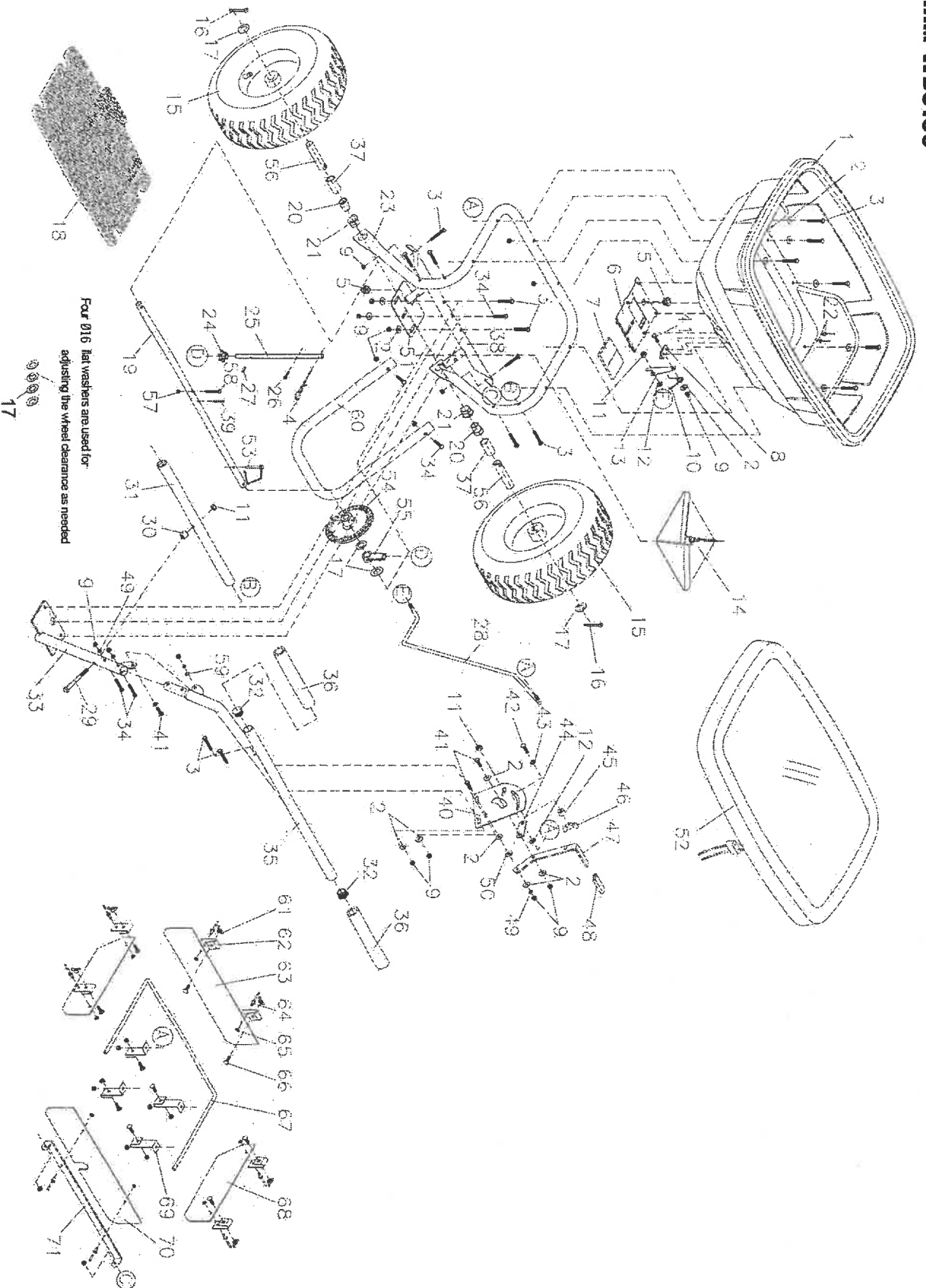

PARTS LIST - WBS130

No.	Item	QTY
1	Hopper	1
2	Large washer $\Phi 6$	16
3	Hex bolt M6 \times 40	16
4	R pin $\Phi 3$	1
5	Shaft Sleeve	2
6	Fixed Adjustable Plate	1
7	Active Adjustable Plate	1
8	Base for Spring	1
9	Lock Nut M6	27
10	Spring	1
11	Lock Nut M8	3
12	Flat Washer $\Phi 8$	2
13	Fixed Plate for Connecting Rod	1
14	Impeller	1
15	Wheel	2
16	Cotter Pin $\Phi 5 \times 35$	2
17	Flat Washer $\Phi 16$	8
18	Screen	1
19	Axle	1
20	Inner Axle Bushing	2
21	Outer Axle Bushing	2
22	Open Type Blind Rivets	2
23	Frame Tube Assembly	1
24	Pinion Gear	1
25	Swivel Axle	1
26	Screw	1
27	Spring Pin	1
28	Adjustment lever	1
29	Hex Bolt M8 \times 75	1
30	Spacer	1
31	Fixed Crossover Tube	1
32	Plastic Cap	2
33	Support Leg	1
34	Hex Bolt M6 \times 35	5
35	Handle	1

No.	Item	QTY
36	Handle Cover	2
37	Axle Bushing	2
38	Crossover Tube	1
39	Spring Pin	1
40	Scale plate	1
41	Hex Bolt M6 \times 20	4
42	Cup Head Square Neck Bolts	1
43	External Tooth Locking Washer	1
44	Connecting rod connecting plate	1
45	Spacer	1
46	Wing Nut M6	1
47	Adjustment handle	1
48	Handle Cover	1
49	Spring Washer $\Phi 6$	4
50	Nylon pad	1
51	Rotating shaft positioning plate	1
52	Rain Cover	1
53	Caster pin sleeve set	1
54	Active Wheel	1
55	Rotating shaft positioning Base	1
56	Tire bushing	2
57	Lock Nut M5	1
58	Hex Bolt M5 \times 40	1
59	Flat Washer $\Phi 6$	2
60	U-Shape Support Leg	1
61	Wing Nut M6	6
62	Short Hanging Board	6
63	Front Baffle	1
64	Open-Cut Blind Rivets	8
65	Flat Washer $\Phi 5$	8
66	Cup Head Square Neck Bolts	10
67	Suspension Rod	1
68	Side Baffles	2
69	Hanging Board	4
70	Rear Baffle	1
71	Rear Baffle Mounting Plate	1